

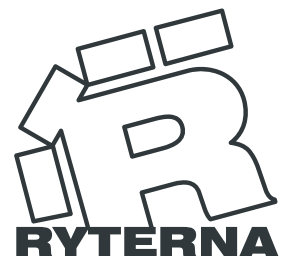

SIDE HINGED GARAGE DOORS



The best option

RYTERNA



One-stop comprehensive solutions

A wide range of product portfolio: garage, industrial, high-speed doors, front doors, gates and fences. Comprehensive and matching solutions from one manufacturer.



Door durability

Extra thick panel tin skin on the outside and inside: 0.5 mm on embossed smooth, 0.7 mm on Slick design panels. Durable and more secure garage doors have longer service life.



Sealing options

All-round perimeter soft rubber sealing to prevent draughts.



Versatile colour options

We can paint in almost all RAL, NCS, and BS colours. A wide range of colour choices will fulfil the highest design requirements.



Custom sizes

All products are made-to-order for fast and precise installation without additional costs for cutting or adjusting on site.



Ergonomic packing

Our ergonomic packing allows for easy door handling and transportation without requiring specialised lifting equipment in the warehouse and on the installation site.

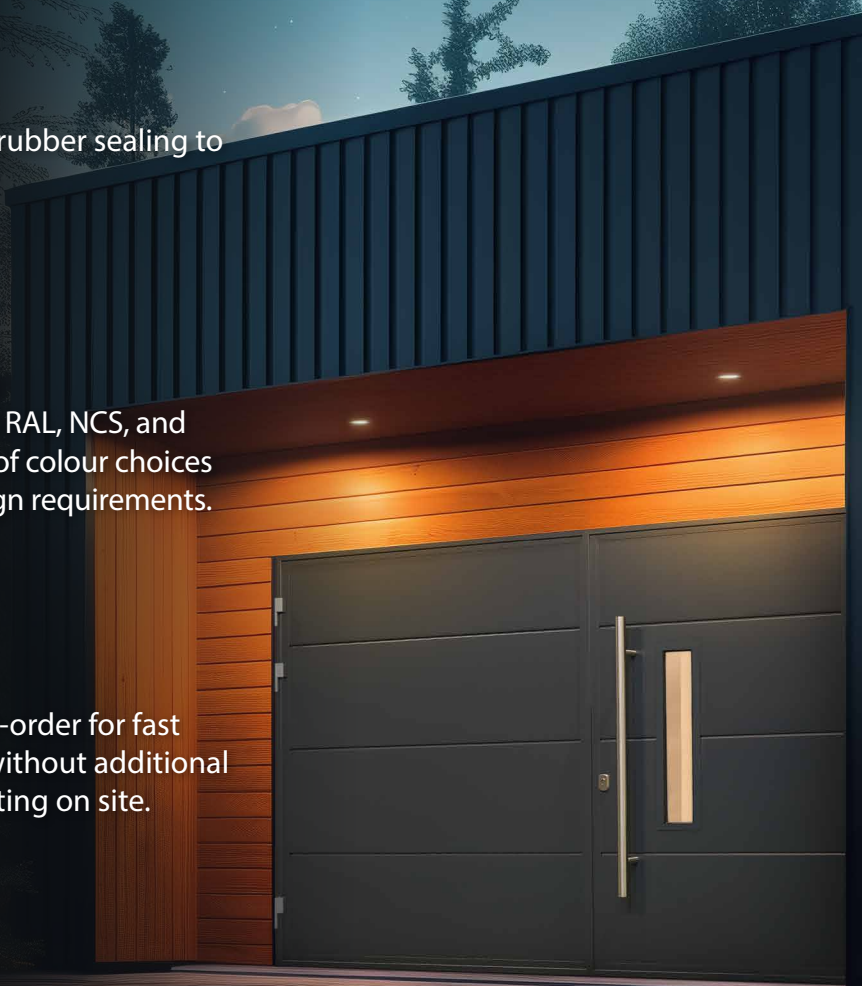



04 TRADITIONAL

08 MODERN

10 RETRO

12 DIAMOND

14 DECOR ELEMENTS

22 GLAZED PANELS

22 UPVC WINDOWS

22 STAINLESS STEEL
WINDOWS

23 HANDLES

23 ACCESSORIES

27 THERMO

CONTENT

Traditional

This is our timeless classic design door. This elegant door offers a perfect blend of tradition and modernity. Doors are made to enhance your home's beauty while providing exceptional functionality. Double-glazed panels can come in three different designs plain, 'cross', or BS. Choose clear, matt, obscure, or tinted glazing to suit your privacy and aesthetic preferences. Acrylic scratch-proof glazing is a standard, but optional safety glass is also available. Along with the almost endless colour options, you can get a perfect match between the garage door and the surrounding setting.



SLICK design panels
RAL 7016 colour
SMOOTH surface
Horizontal layout
Standard glazed panel



MIDRIB design panels
RAL 1001 colour
WOODGRAIN surface
Vertical layout
'Cross' glazed panel

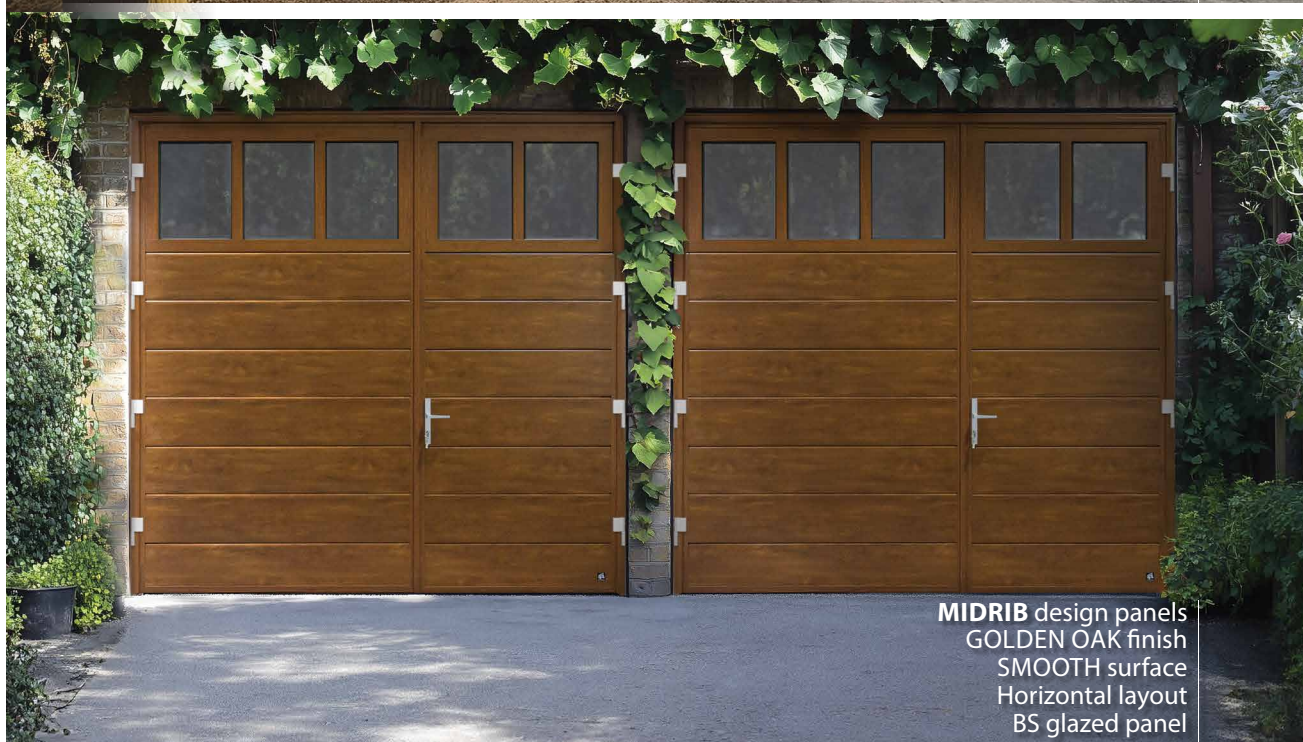

MIDRIB design panels
GOLDEN OAK finish
SMOOTH surface
Horizontal layout
BS glazed panel

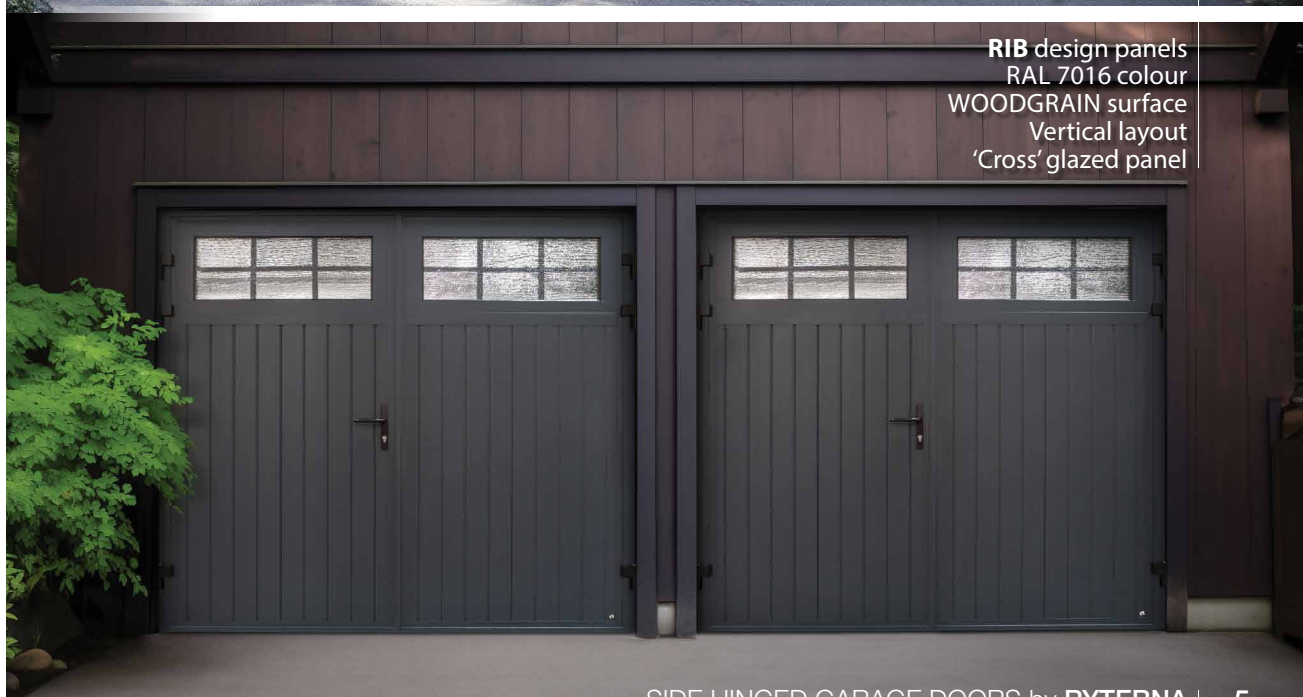

RIB design panels
RAL 7016 colour
WOODGRAIN surface
Vertical layout
'Cross' glazed panel



MIDRIB design panels
RAL 7032 colour
SMOOTH surface
Vertical layout
'Cross' glazed panel



RIB design panels
RAL 9004 colour
WOODGRAIN surface
Vertical layout
'Cross' glazed panel

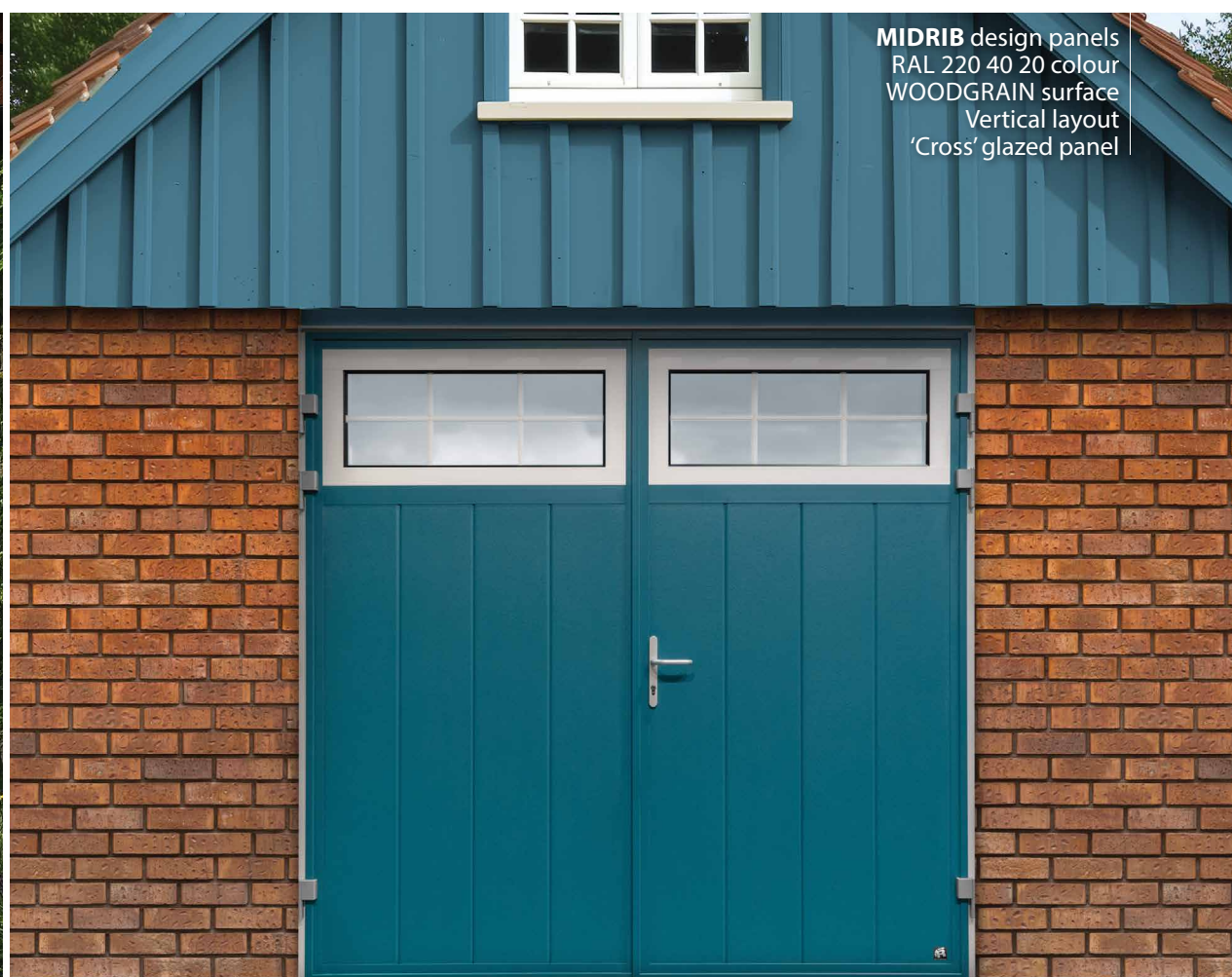

Modern

Our Modern design door combines modest luxury with exceptional functionality and performance. Elegant Vertical Layout gives a sleek and contemporary look. Slim Glazed Panels with different glazing options let the natural light inside while maintaining privacy. Brushed stainless steel pull handles are a perfect addition to enhance your kerb appeal.



SLICK design panels
RAL 9016 colour
SMOOTH surface



SLICK design panels
RAL 7016 colour
SMOOTH surface
DESIGN 609

FRONT DOOR RD80
RAL 7016 colour
DESIGN 609



SLICK design panels
RAL 9016 colour
SMOOTH surface



SLICK design panels
RAL 7016 colour
SMOOTH surface

Retro

Put a touch of 'good old' days for your home. The timeless design resembles the old fortress or castle door. Plenty of design elements are available to get the precise look you desire.



RIB design panels
RAL 9016 colour
WOODGRAIN surface
RETRO S



RIB design panels
RAL 9016 colour
WOODGRAIN surface
TRADITIONAL + RETRO X

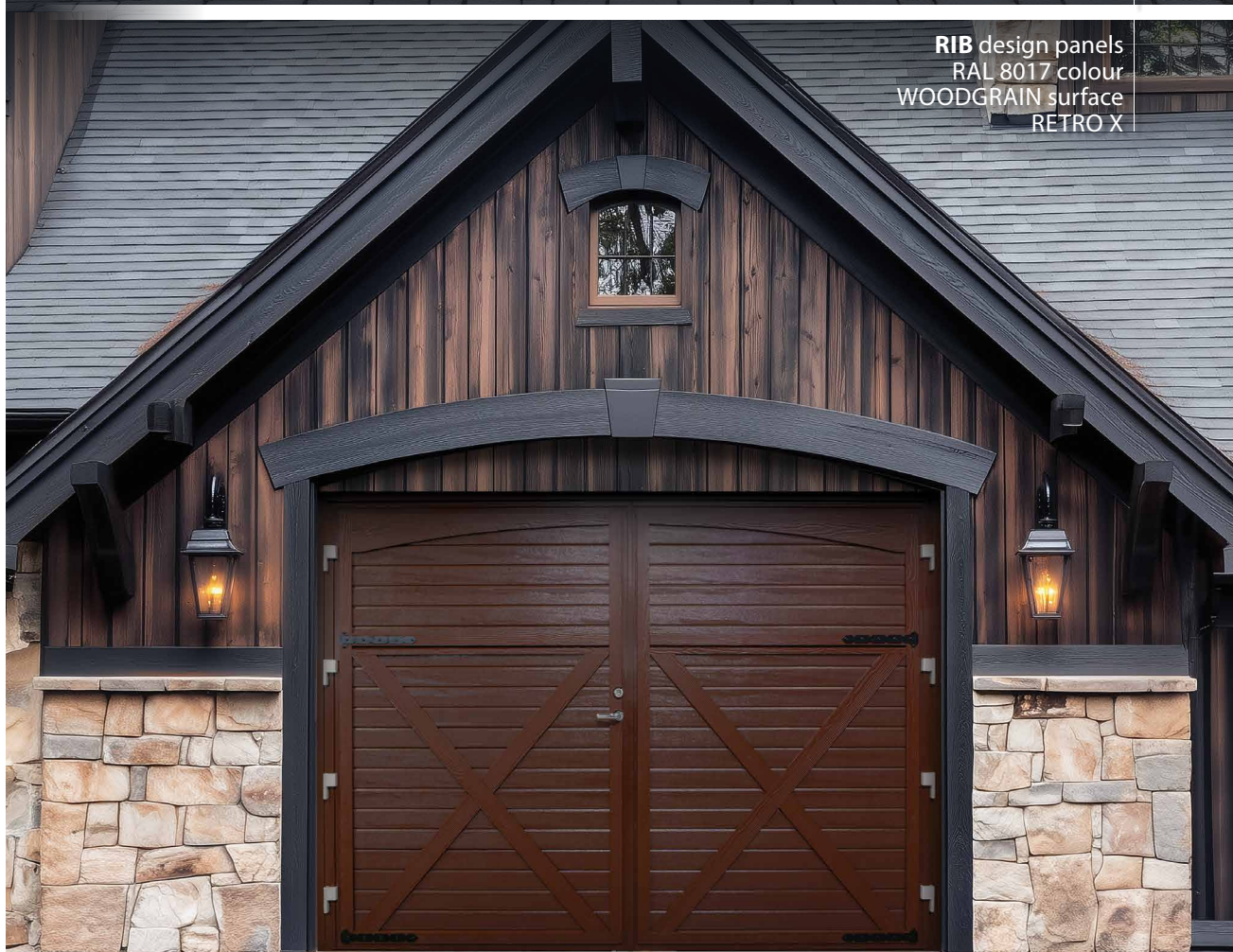

RIB design panels
RAL 8017 colour
WOODGRAIN surface
RETRO X

Diamond

'Diamond' design door can turn your house into a really 'home sweet home'. Double-design panels arranged in a chevron pattern add a touch of sophistication and elegance to your entrance. In addition with 8 square 15x15 cm stainless steel windows, this door looks cosy and welcoming.



FLUSH + RIB design panels
RAL 1007 colour
WOODGRAIN surface
Chevron layout



FLUSH + RIB design panels
RAL 7001 colour
WOODGRAIN surface
Chevron layout

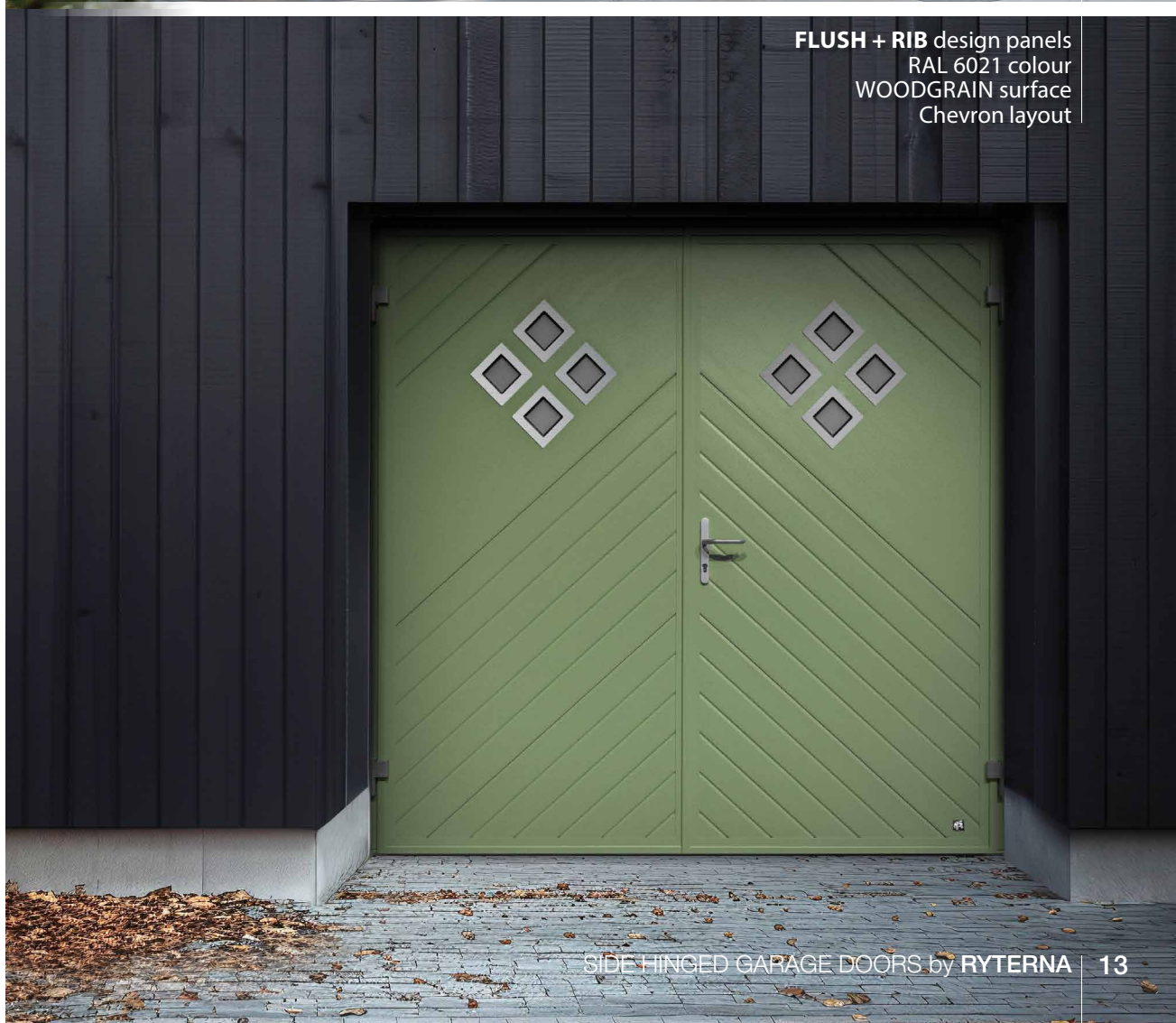

FLUSH + RIB design panels
RAL 6021 colour
WOODGRAIN surface
Chevron layout

Decor elements

Stainless metal decals give exceptional accents to your door. You can turn a standard appearance door into something individual. We offer a wide range of standardised designs along with the possibility to create your own. Playing with the combination of brushed stainless steel handles, stainless steel windows and metal decals you can get staggering kerb appeal.



SLICK design panels
RAL 7016 colour
SMOOTH surface
Tree motif decor



For more options see,
DESIGN by RYTÉRNA catalogue



TOPRIB design panels
RAL 7016 colour
SMOOTH surface
Decor A-25



SLICK design panels
RAL 6009 colour
SMOOTH surface
Kick plate



SLICK design panels
RAL 7016 colour
SMOOTH surface
Stainless steel windows frames
powder-coated





FLUSH design panels
RAL 9005 colour
WOODGRAIN surface
Custom decor



FLUSH design panels
RAL 3003 colour
WOODGRAIN surface
Decor A-39



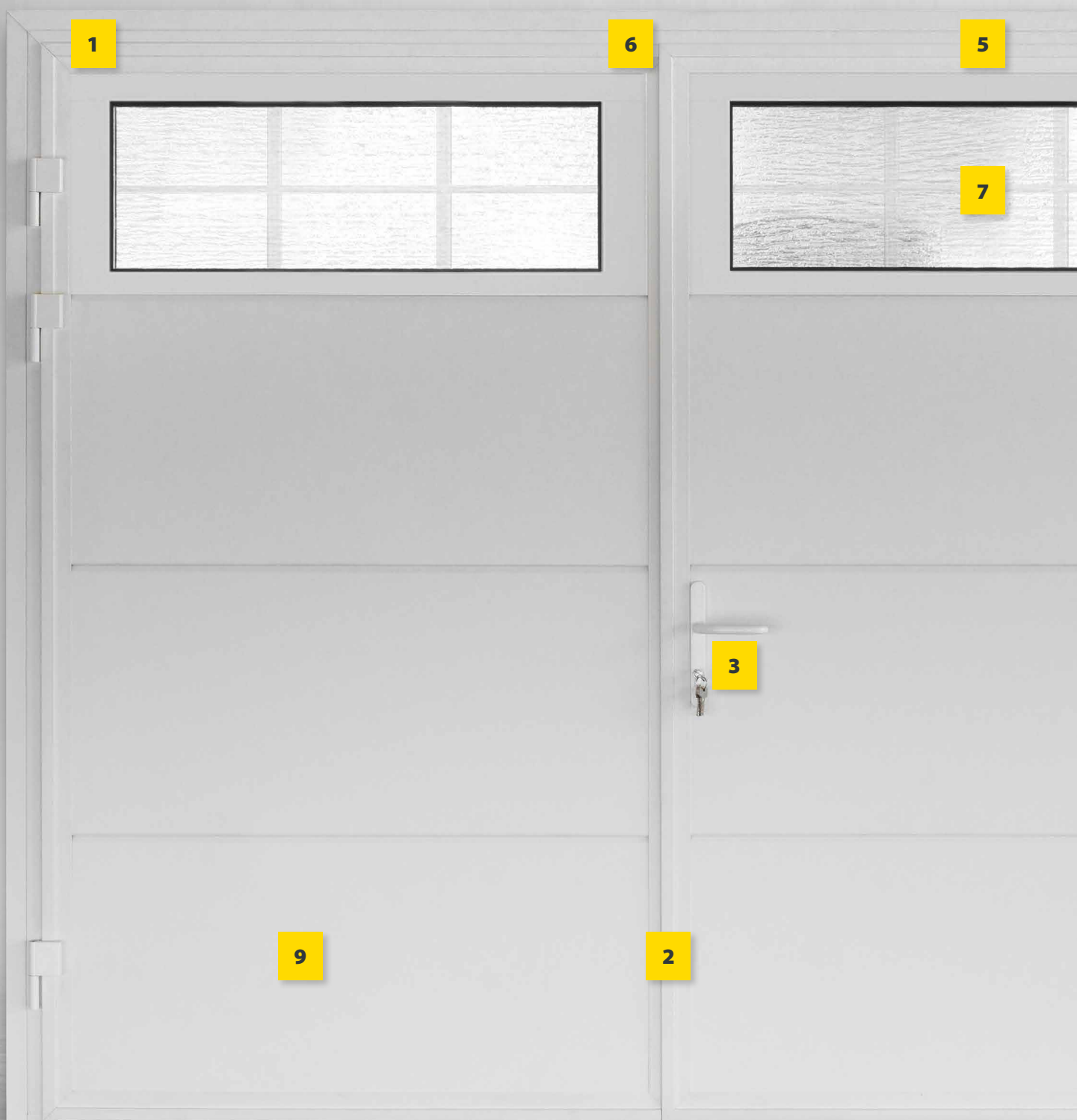

Frame mouldings: this option allows the door to be fitted flush with the front wall, hiding any small gaps or crumbled brickwork. Same colour as the frame. On the left side: frame with moulding; on the right: without moulding.

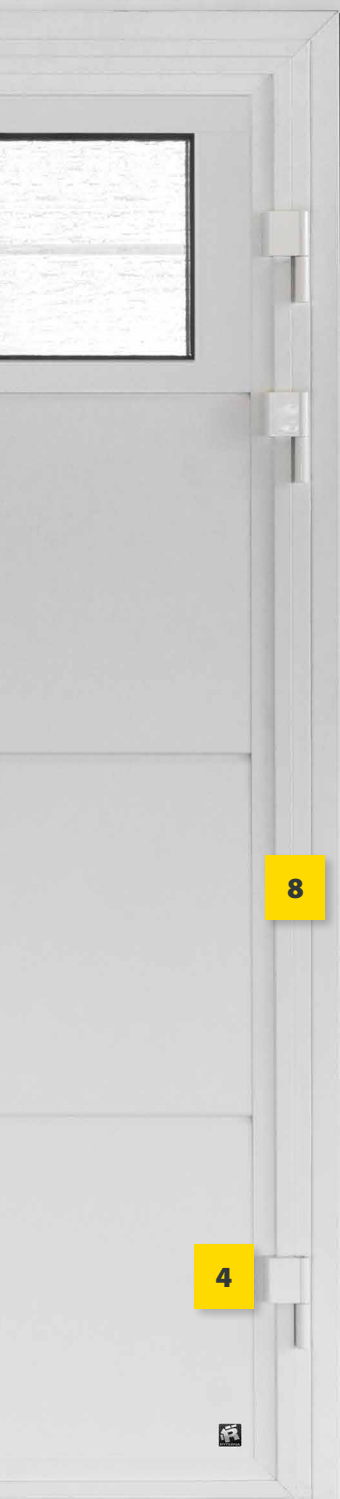

2



The first door leaf can be left-hand or right-hand swing. The door split can be 50/50, 30/70, or any other reasonable proportion. Maximum leaf width: 1.5 metres.

3



As standard, a one-point lock is provided. For higher security, 3-point or Assa-Modular locks are available as options. All locks come with 5 keys.

4



Adjustable aluminium alloy hinges with bearings. Standard colours: white, black, and silver.

5



The canopy profile diverts rainwater from penetrating between the frame and the leaf.

6

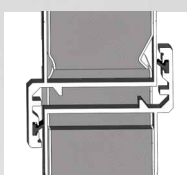

Improved C-shaped soft rubber sealing around the entire perimeter and between the leaves.

7

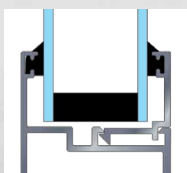

Scratch-proof, energy-efficient double glazing with acrylic glass.

8

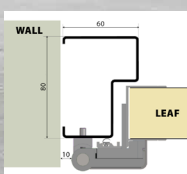

Rebated, zinc-coated, robust, and maintenance-free steel frame. Painted the same colour as the door, or a different colour if specified.

9

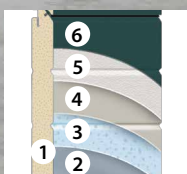

Energy-efficient insulated door panels with a double steel skin filled with freon-free PU foam: 1 - 40 mm thick foam; 2 - steel; 3 - zinc; 4 - primer; 5 - finish coating; 6 - colour.



1



Clear, scratch-proof, matt, or obscure glazing. An internal cross can be added. Frames powder-coated door or different colour.



2-3



Optional espagnolette lock to keep the second leaf in the closed position.

4



Designed to make opening the second door leaf effortless. Standard option: integrated two shoot bolts on the second leaf.

5



Key cylinder with thumb-turn. Convenient option for quick door locking from the inside without a key.

6



Heavy-duty door stays hold the door leaf in the open position. Easy to lock and release. Safe to use, even on windy days.

7



Adjustable leaf opening angle from 90 to 140 degrees.

8



4 hinge bolts. Increased burglar resistance.

9



Stainless steel cover for the S5 threshold. Enhances the appearance of side hinged doors and protects the threshold paint from wearing off.

10

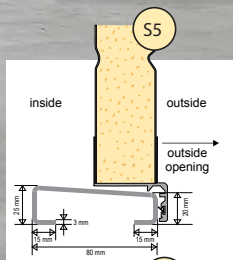

Standard S5 sloping threshold made from zinc-coated steel profile. Optional: stainless steel plated. S1 and S4 thresholds are also available. A 30 mm raised threshold is available.

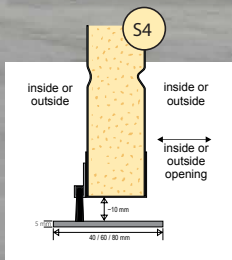
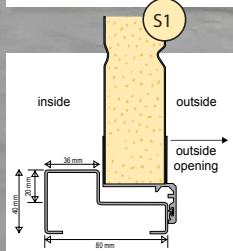

Glazed panels

Glazed panels are powder-coated in a matching colour. Acrylic double-glazed windows can be clear, matt, obscure or tinted. We offer glazed panels with safety glass double glazing as well.



Clear



Matt



Obscure

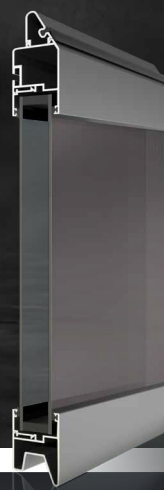

Tinted

UPVC windows

UPVC windows are the cost-wise solution if you want daylight inside the garage or simply uplift the appearance of the garage door. Acrylic double glazing can be plain or with deco inserts.



Stainless steel windows

3 different shapes and 7 sizes of stainless steel windows will meet the most demanding design requirements. Square windows can be placed in a diamond shape and oblong windows - horizontally or vertically according to door layout.



155x155 mm
235x235 mm
315x315 mm



Ø155 mm
Ø235 mm
Ø315 mm

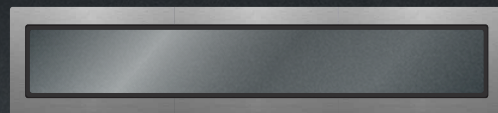

805x155 mm

Handles

Standard handles



White 22050



Black 22050



Silver 22050

Optional handles



Stainless steel HLS 02



Stainless steel HLS 03



Stainless steel HLS 04



Stainless steel HLS 05



Stainless steel HLS 06



Stainless steel HLS 12



Stainless steel
anti-panic handles 22035



Chrome plated
ASSA Modular 565



Fixed knob 22046

500 mm	H90S-500
800 mm	H90S-800
1200 mm	H90S-1200
1400 mm	H90S-1400
1800 mm	H90S-1800

Stainless steel pull handle
Square bar

500 mm	H90R-500
800 mm	H90R-800
1200 mm	H90R-1200
1400 mm	H90R-1400
1800 mm	H90R-1800

Stainless steel pull handle
Round bar

Accessories



RAL painted ventilation grill



Pet flap



Integrated mailbox



Letter plate

Thermo

Thermo side-hinged garage door with improved thermal insulation. Due to the frame and profiles with a thermal break, this type of door is a perfect solution for garages converted into hobby spaces, workshops, utility rooms, etc.

We offer four door main design options:

S+FV - with safety glass double-glazed panel and aluminium sheet 'sandwich' type infill,

S - with aluminium sheet 'sandwich' type infill,

P+FV - with safety glass double-glazed panel and 'Slick' design panel infill,

P - 'Slick' design panel infill.



Rain resistance

PN-EN12208:2001

Class 6A



Thermal transmittance

SH2T P 3000x2600 mm

~1.2 W/m²K



Wind resistance

PN-EN12210:2016

Class C3



Air permeability

PN-EN12207:2017

Class 4



THERMO P
SLICK panel infill
RAL 7016 colour



THERMO S+FV
Sandwich type infill
RAL 7033 colour



THERMO P+FV
SLICK panel infill
RAL 9010 colour



THERMO S+FV
Sandwich type infill
RAL 7016 colour



THERMO S+FV
Sandwich type infill
RAL 7030 colour

Standard options



Handle
(standard colours: white, black, silver)

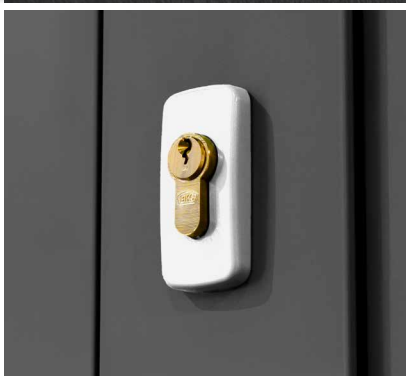

Escutcheon
(standard colours: white, black, silver)



Hinges
(standard colours: white, black, silver)



Door stays



Double clear safety glazing / matt



Integrated shoot bolts

Additional options

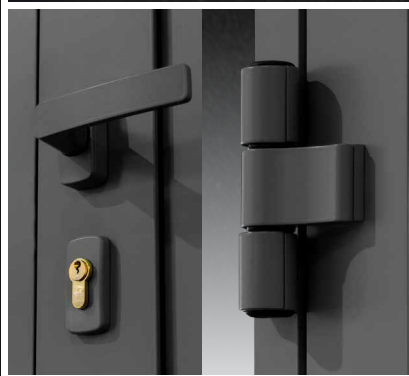

Custom colour hinges and handle



Integrated espagnolette



'Stabilus' gas door stays



Fixed knob with escutcheon
(colours: black, white, silver)



Custom sand blasted glazing



3-point lock

matching



GATES & FENCES



GARAGE DOORS



FRONT DOORS

It's never been easier to get a unique matching design. Front and garage door, aluminium gate and fence from one manufacturer. Same design, same colour, same accents - hassle-free.

The images in this catalogue showcase different configurations and may include additional non-standard accessories. • **RYTERNA** reserves the right to implement improvements and update designs without prior notice. • The depicted colours in this brochure are illustrative and may vary from actual product colours. • **All rights reserved.** • Unauthorised reproduction or distribution of this catalogue in whole or in part is available only with consent from **RYTERNA**.

